

Shape your world



Ritsumeikan
Asia Pacific University

RITSUMEIKAN ASIA PACIFIC UNIVERSITY



BEPPU, JAPAN

SHAPE YOUR WORLD

**FREEDOM, PEACE, HUMANITY.
INTERNATIONAL MUTUAL UNDERSTANDING.
THE FUTURE SHAPE OF THE ASIA PACIFIC REGION.**

Ritsumeikan Asia Pacific University (APU) first opened its doors in 2000 with these ideals as its foundation. What emerged was an entirely new multicultural learning environment with the aim of creating global leaders across all fields and industries. In these past seventeen years, this goal has not only been reached but exceeded as thousands of students from over one hundred thirty countries have come together to learn intercultural coexistence, responsible business leadership, and sustainable development. With this well-rounded base of global knowledge, APU students and graduates are actively finding solutions to the issues our world is facing.

Your path to shape your own world and the world around you starts at APU.

- 1 SHAPE YOUR WORLD**
- 3 APU BY THE NUMBERS**
- 5 ACADEMICS**
- 7 COLLEGE OF
INTERNATIONAL MANAGEMENT**
- 9 COLLEGE OF
ASIA PACIFIC STUDIES**
- 11 LANGUAGE EDUCATION**
- 12 SUBJECT LIST**
- 13 EXCHANGE PROGRAMS**
- 15 EXTRACURRICULAR
ACTIVITIES**
- 17 STUDENT LIFE**
- 21 CAREERS**
- 23 ALUMNI JOURNEYS**
- 25 ADMISSIONS GUIDE**

All data and statistics are current as of the
2016 Academic Year.

APU BY THE NUMBERS

5,848 total students

90 countries and regions represented by students

138 exchange partners in **46** countries

91.6% employment success rate

50.3% international students

25 countries and regions represented by faculty

88 ambassadors on APU's advisory committee

Selected by the Government of Japan in 2014 as one of the country's
"TOP GLOBAL UNIVERSITIES"

140+ student-led organizations

138 countries and regions represented by alumni

4,116 APU and external scholarship recipients

3RD Japanese university to date to become **AACSB**-accredited

EDUCATION THAT INSPIRES YOU

Curious, adventurous, energetic, creative, dedicated... These are some of the words which define APU students. You will find they are passionate about being involved; about learning new languages, understanding new cultures, exploring global business, and solving problems of communities across the world. Couple this mindset with the world-class education offered at APU, and our graduates emerge as a new dynamic generation of global leaders. We invite you to utilize this completely unique environment to get ready to make a positive impact on a global level.

CUSTOMIZE YOUR STUDIES

While Japan sets the stage for life at APU, the education offered here is internationally focused. Most of our academic courses are available in both English and Japanese. You will choose between two undergraduate majors—Asia Pacific Studies (APS) and International Management (APM)—and study in the language of your choice. You can also customize your studies by taking a number of classes offered in the other major, creating a study pathway relevant to your future.

STUDY IN ENGLISH, LEARN JAPANESE

Knowing more than one language is not a goal for our students—it's a requirement. Studying your degree in English means you will also be required to learn Japanese and vice-versa. Want to add another language to your repertoire? APU makes it possible.

ENGAGE WITH WORLD-CLASS FACULTY

Highly qualified faculty from twenty-five countries, many of whom have real-world experience, bring a new dimension of practical learning to the classroom. Learn about issues affecting your world from esteemed practitioners who have honed their skills at the cutting edge of innovation over decades.

KEEP THE FOCUS ON YOU

APU's interactive style of education creates daily opportunities for lively discussions and group work with students of different cultural and socioeconomic backgrounds in a variety of classroom settings. You will become an independent and proactive learner able to think critically and creatively about the issues facing the world.

GO BEYOND THE CLASSROOM

Learning at APU is not simply a matter of reading books and attending lectures. We invite you to take your knowledge, turn it into action and make an impact out in the world that exists beyond the classroom. From field studies, exchange programs, conferences, academic competitions, to community outreach and internships, get involved in the vast range of opportunities that await you at APU.

COLLEGE	AREAS OF STUDY
College of International Management (APM) <i>Bachelor of Business Administration (BBA)</i>	<ul style="list-style-type: none">· Innovation and Economics· Marketing· Strategic Management and Organization· Accounting and Finance
College of Asia Pacific Studies (APS) <i>Bachelor of Social Science (BSocSc)</i>	<ul style="list-style-type: none">· Environment and Development· Hospitality and Tourism· International Relations and Peace Studies· Culture, Society and Media

You need 124 academic credits in order to graduate. Average time until completion is four years. There are also options to graduate in three or three and a half years.



COLLEGE of INTERNATIONAL MANAGEMENT [APM]

BACHELOR OF BUSINESS ADMINISTRATION (BBA)

Cultivate your own global perspectives, business ethics, and problem-solving skills in APM in order to join the next generation of international business leaders.

The College of International Management is accredited by the Association to Advance Collegiate Schools of Business (AACSB International), which is widely regarded as the highest level of accreditation for business schools worldwide. This means you will enjoy world-class instruction as well as have access to various exchange opportunities with our top business school partners across the globe.

As a student in APM, you will begin your studies tackling core management concepts and then branch out into your specialized field of interest. A capstone course during your last year will put you in real-time business discussions with company executives and challenge you to use essential business skills. You will also be encouraged to take part in business case competitions organized both on campus and internationally.

AREAS OF STUDY

INNOVATION AND ECONOMICS

Learn about what generates innovation, how production is managed, and the underlying economic foundations of these concepts. The lectures are geared towards those wishing to contribute to global development through business or policy-making.

MARKETING

The theories and methods needed to successfully provide goods and services to the global market is the focus of courses in the marketing area of study. You will learn to identify the most effective method to link production to the final consumer and determine how much to provide at what cost.

STRATEGIC MANAGEMENT AND ORGANIZATION

These classes focus on how to set goals, establish principles, and develop methods for an organization so that it meets the challenges of evolving social needs. If you aim to become an entrepreneur or plan to take over your family business, this area of study is ideal for you.

ACCOUNTING AND FINANCE

The health of corporations is evaluated by the ebb and flow of money, which is known as accounting, while finance is the field concerned with raising and managing the funds necessary for corporate activities. Classes in this area of study enable you to gain a solid foundation in these demanding fields and exercise your knowledge in an international context.



SEMINAR CLOSE-UP: CORPORATE SOCIAL RESPONSIBILITY

Conducting business nowadays is more than just maximizing profits. Sustainability must also be considered, as it is not only vital to the global community and the environment but also to a business's success. A recent rise in awareness of such sustainability issues by various stakeholders not only draws positive attention to businesses that give back to society at large, but also is a factor for those seeking employment. Employees now favor organizations that manage with honesty and transparency while also having a positive impact on societal and environmental well-being.

In this class you will learn to think critically and analyze the current business landscape from the angles of social responsibility and sustainable management. We will review and discuss policies, initiatives, and practices by various businesses, and how these affect the different functions of a company, such as operation, sales and marketing, human resources, etc. This third-year seminar class is also designed to develop your research skills if you are aiming to write a thesis in your fourth year. As part of this process, I will guide you in finding your research question. I will also encourage you to view issues against various international dynamics and to determine how you can contribute to global society in a responsible and sustainable way.

As a piece of personal advice, I urge you begin developing competitive skills and professional value while you are still a student. After graduating from university, you will join the real world where organizations seek out those with unique talents and outstanding skills. Think about what you can offer that is different from others and what organizations would be willing to pay you for. Never stop evaluating, improving, and leveraging such competitive advantages. With this mindset, I am confident that you can succeed in becoming a respectable CEO, entrepreneur, consultant, leader of a multinational corporation, or any other role you endeavor to reach.

Professor Rebecca Chunghee Kim (Korea)

Degree: Ph.D. (Management Research), University of Strathclyde



In this course we are encouraged to take a 360-degree approach towards decision-making, which leads us to carefully examine how the possible consequences of our actions affect every stakeholder in a business. Through this approach, we study how to create "win-win" situations so that the business not only fulfills its economic and legal duties but also makes social contributions. Acquiring both theoretical knowledge and awareness of best business practices in this course is preparing me for my dream of becoming a top-level executive and starting my own consulting firm that helps businesses exercise their social responsibility.

My life at APU has been very fulfilling as I have had the chance not only to push my academic limits in multidisciplinary courses like this, but also to make friends from so many countries to the point that any kind of difference just "feels normal". While enhancing my knowledge, I also work with many amazing people in some of the student organizations we have on campus. I have become more independent in taking care of myself, confident in finding my career path, and eager to take advantage of all the opportunities available to me. But above all, I have learned that making friends and supporting one another to reach new heights is so important because an achievement can't be truly enjoyed if no one is there to enjoy it with you.

Jareef Bin Martuza (Bangladesh)

APM, 3rd Year Student

COLLEGE OF ASIA PACIFIC STUDIES [APS]

BACHELOR OF SOCIAL SCIENCE (BSocSc)

In APS, we challenge you to tackle a vast array of global issues and develop new ways of thinking to face these obstacles head on. You will gain a broad understanding of the political systems, economies, societies, and cultures of the Asia Pacific while gathering relevant skills in language and information technology. Between your second and sixth semester, you will be able to choose an area of study to specialize in and embark on more in-depth studies and research. APS prepares you for a wide variety of careers in government, international organizations, media, the travel industry, and multinational corporations.

AREAS OF STUDY

ENVIRONMENT AND DEVELOPMENT

Profit-driven development has brought with it a raft of environmental and other issues, and sustainable development is an urgent issue for our times. Lectures in this area of study tackle this question of sustainable development in relation to efforts to balance environmental conservation and economic development. You will also examine sustainable development policies in light of the systems and laws in each country and region.

HOSPITALITY AND TOURISM

As cultural exchange and promotion of regional industries through tourism are vital to the development of the Asia Pacific region, this area of study explores multiple facets of tourism through the lenses of culture, society, and community. You will focus on the theory and practice of hospitality management as it relates to the tourism, health, service, and welfare industries.

INTERNATIONAL RELATIONS AND PEACE STUDIES

This area of study allows you to delve into the intricacies of conflict resolution and peace-building as well as to cultivate the ability to deal with increasingly complex global issues in order to become a future expert. Your studies will draw from the three disciplines of international law, political science, and economics and help you gain the necessary critical thinking skills and a policy-oriented approach to succeed in the fields of international relations, dispute resolution, and peace-building.

CULTURE, SOCIETY AND MEDIA

This area of study enables you to analyze the societies, cultures, and values of the Asia Pacific to deepen your understanding of the issues this region faces. Your coursework will include study on information technology, culture, and new media. Through this, you will gain a global perspective, fundamental media skills, and the ability to view the region from several angles.



SEMINAR CLOSE-UP: CULTURE, SOCIETY AND MEDIA

Most students who take my research seminar in Culture, Society and Media do so because they are interested in learning more after completing one of my lecture courses. These lecture courses provide a basis for further study as they focus on topics in education, history, and religion, and offer a multidisciplinary approach to understanding these topics by combining cultural studies, sociology, and media studies.

By joining this seminar you will explore your interests in Culture, Society and Media and, in a setting infused with the spirit of collective inquiry, you will pursue a full-fledged research project of your own design under my guidance. My goal is for you to make the transition from being students—where someone tells you what to study, when to study, why to study, and how to study—to independent learners, where you make these decisions for yourselves. At the end of the seminar, you will produce and present on an extensive piece of writing on a topic of your choice and in doing so, attain both public speaking and academic writing skills beneficial to a variety of careers.

The multidisciplinary outlook and skills that you acquire from my research seminar will enable you to qualify for graduate school in a wide range of fields, from cinema studies to sociology and beyond. Some of my former students obtained positions in the private sector, joining large international companies and small businesses both in Japan and abroad. Others entered the public sector, working for NGOs, NPOs, and educational institutions. A few students have also gone on to successful careers in music performance and media production, while one graduate recently entered medical school.

The sky is the limit for the achievements of Culture, Society and Media graduates, and I attribute this impressive array of outcomes to the combination of their social science and humanities knowledge and strong research skills developed in a supportive environment. Throughout your time with me at APU, I will encourage you to strive towards three overarching goals: develop a useful skill, learn the care of the self, and find your joy. I will also remind you that before you can shape your world, you need to fully understand it.

Professor Joseph Progler (United States)

Degree: Ph.D. (American Studies), University at Buffalo,
The State University of New York



The two most valuable skills that I gained from this seminar class were to think critically and to write logically. I also learned that understanding how to construct and carry out independent research can lead one achieving to greater goals in life. As such, I have determined that I would like to pursue an academic career as a professor. This interest was fueled not only by my enjoyment of writing a thesis, but also through my part-time work at APU as a writing tutor, a language peer advisor, and a teaching assistant. I believe that as an academic, I can work on what interests me while contributing to society through passing on knowledge to the next generation.

Under the knowledgeable, meticulous, and caring supervision of Professor Progler, I not only gained knowledge in social, anthropological, and media studies, but also developed a mindset to view things holistically while simultaneously observing its details. More than just academics, Professor Progler often incorporated important life skills in his classes, such as how to care for ourselves without failing to look after others. I was happy that I became a more responsible person under his guidance.

Completing your undergraduate studies is a transition period during which you will need to make important decisions for your future. Whatever option you ultimately choose, let it be one that is useful and delightful.

Hong Ngoc Doan (Viet Nam)

APS, 4th Year Student

CONNECTED BY LANGUAGE

Communication is the first step to international understanding, and language is one of the primary tools that makes it possible. A new language also brings a new mindset that enriches your perspective. Acquire another language through APU's language classes, and you will have a significant advantage in your future career whether it is based in your home country, Japan, or another location.

I have always had a hunger to learn languages and become a polyglot. So when the opportunity to attend APU and learn Japanese presented itself, I did not hesitate in seizing it. For me, Japanese is a different language—different, not difficult, being the keyword. With no prior background in Japanese, I started my studies with the sessions held at AP House to learn the *hiragana* and *katakana* alphabets during the new student orientation period. Once classes started, I took Japanese Foundation I, II, and III and then proceeded on to Intermediate Japanese. These were intense, but I noted a remarkable difference in my language skills from very early on. Having a part-time job in Beppu helped me as well as it served as a true language immersion experience; you are put in an

MASTER JAPANESE

As a student undertaking your studies in English, you are also required to take Japanese language classes as an essential component of your degree. Regardless of whether you have prior Japanese language training or not, we have all levels of classes from beginner to advanced, to suit your ability at enrollment. (The reverse applies to students studying their major in Japanese.)

BECOME MULTILINGUAL

If you aim to learn more than one language, APU offers additional language courses in the Asia Pacific languages of Chinese, Korean, Malay/Indonesian, Spanish, Thai, and Vietnamese. Raise your proficiency in these languages by participating in one of APU's language immersion programs available in several different countries around the world.

environment with native Japanese speakers, which automatically challenges you to use what you've learned in class. Out of all the Japanese phrases I know now, *wakarimashita* (I understand) is my favorite. This draws back memories of the early days when I couldn't understand a single word of Japanese. Now, being able to use this phrase gives me such a good feeling because it shows I understand the content of what is being said to me. I encourage you to never be afraid of mistakes when learning Japanese because this is how you improve and build up your skills.

Karlton W. Kaunga (Kenya)
APS, 3rd Year Student

SUBJECT LIST

This list consists of subjects in the 2017 curriculum, effective from April 1, 2017, for students who enroll in APU from April 2017 and onward. Students enrolled before April 1, 2017 will continue to study under their current curriculum.

LIBERAL ARTS SUBJECTS

APM Bridge Program APS Bridge Program Bioethics Career Design I-II-III-IV Computer Literacy Constitution of Japan Culture and Society of the Asia Pacific Data Mining Database Systems Economy of the Asia Pacific Environmental Science Geography of the Asia Pacific Health Science History of the Asia Pacific Intercultural Fieldwork I-II Internet Technology Integration Internship Introduction to Culture and Society Introduction to Development Studies	Introduction to Economics Introduction to Environmental Studies Introduction to GIS Introduction to Intercultural Communication Introduction to International Relations Introduction to Media Studies Introduction to Peer Leader Training Introduction to Political Science Introduction to the Internet Introduction to Tourism and Hospitality Japanese Art of Flower Arrangement Japanese Art of Tea Ceremony Japanese Culture and Society Japanese Economy Japanese Geography Japanese History Languages of the Asia Pacific Legal Studies Logical Thinking and Framework	Media Production Lab Multicultural Collaborative Workshop Negotiation Skills Overseas Learning Design Peace, Humanity and Democracy Peer Leader Training I-IIA-IIB Programming Psychology Religions of the Asia Pacific Special Lecture (ICT) Special Lecture (Japanese Studies) Special Lecture (Liberal Arts Subject) Statistics Studies of Multicultural Comparison Study Skills and Academic Writing Traditional Japanese Arts Volunteer Activities
---	--	---

LANGUAGE EDUCATION SUBJECTS

Japanese Language Classes Business Communication in Japanese A-B Career Japanese Japanese Course (Foundation/Intermediate/Pre-Advanced/Advanced) Japanese for Lectures Japanese Project A-B-C-D-E-F Language and Culture in Japan Language and Social Topics in Japan	English for Business Writing English for Discussion and Debate English for Journalism English Project 1+2 Extensive Reading in English of the Media	Specific Language Classes English Proficiency Preparation Course I-II-III Intensive Language Learning Overseas Introduction to Asia Pacific Languages Introduction to Official Languages of the United Nations I – French Introduction to Official Languages of the United Nations II – Russian Introduction to Official Languages of the United Nations III – Arabic Japanese Language Teaching Japanese Linguistics for Japanese Language Education Special Lecture (Language Education Subject) TESOL
--	---	---

APM SUBJECTS

Required Subjects Accounting I Advanced Mathematics Business Ethics Finance Fundamental Mathematics Global Management (Capstone) Introduction to Management Introduction to Marketing Legal Strategy in Business Management of Human Resources and Organizational Behavior Production Management	Accounting & Finance (AF) Accounting II Advanced Accounting Auditing Corporate Finance Cost Accounting Financial Accounting I-II Financial Market and Institutions International Accounting International Finance Investment and Securities Analysis Investment Strategy Management Accounting Special Lecture in Accounting Special Lecture in Finance	Technology Management Marketing (M) Brand Management Consumer Behavior E-Commerce International Logistics International Marketing Marketing Research Product Development Promotion and Sales Management Service Management Special Lecture in Marketing Supply Chain Management
Strategic Management & Organization (SMO) Advanced Human Resource Management Advanced Organizational Behavior Brand Management Entrepreneurship Family Business Management International Logistics International Transactions Service Management Special Lecture in Strategic Management & Organization Strategic Management Supply Chain Management	Innovation & Economics (IE) Asian Economy Development Economics Entrepreneurship International Economics International Political Economy Macroeconomics Microeconomics Operations Research Product Development Special Lecture in Economics Special Lecture in Innovation	APM Common Subjects APM Field Study Business Case Analysis & Communication Business Data Analysis Business Internship Field Research Project Management Information Systems Social Entrepreneurship Special Lecture (Management)

APS SUBJECTS

Core Subjects Introduction to APS Introduction to Area Studies	Media and Culture Media and History Media and Law Media and Politics Multiculturalism and Society New Media and Society NPO/NGO Studies Preliminary Seminar for Culture, Society and Media Religion and Belief Social Psychology Social Stratification Social Theory Sociology of Organizations Special Lecture in Culture, Society and Media The Humanities and Modernity Transnational Sociology	Conflict and Development Development Policy Ethnicity and the Nation State Field Study for International Relations and Peace Studies Foreign Policy of Japan Geo-Politics and Post-Cold War Conflicts Global Issues and Policies Global Media and Conflict Globalization and Law Globalization and Regionalism History of International Politics History of Japanese Foreign Relations Human Rights Identity and Politics International Conflict Resolution International Cooperation International Law International Organizations International Political Economy International Relations in the Asia Pacific International Relations Theory Media and Politics Peace Studies Political Theory Politics of Development Preliminary Seminar for International Relations and Peace Studies Regional Systems in the Asia Pacific Special Lecture in International Relations and Peace Studies Strategic Decision Making Violence and Terrorism
Environment & Development (ED) Biodiversity Community-Based Tourism Community Development Conflict and Development Development Economics Development Policy Development Sociology and Anthropology Ecotourism Environment and Society Environmental Communication Environmental Economics Environmental Modeling and Analysis Environmental Policy Field Study for Environment and Development GIS and Remote Sensing Global Environmental Issues Industrial Ecology International Cooperation International Economics International Organizations NPO/NGO Studies Preliminary Seminar for Environment and Development Politics of Development Project Management in Development Resource Management Special Lecture in Environment and Development Urban Environment and Development	Hospitality & Tourism (HT) Advanced Human Resource Management Advanced Organizational Behavior Agri-heritage and Tourism Community-Based Tourism Cultural Anthropology Culture and History of Tourism Destination Marketing and Management Ecotourism Event and Festival Management Field Study for Tourism and Hospitality Health and Wellness Tourism Heritage Tourism Hospitality Management Hospitality Marketing MICE Tourism Industry Operations Research Preliminary Seminar for Tourism and Hospitality Project Management in Development Resort Development Sociology of Tourism Special Lecture in Tourism and Hospitality Tourism and Hospitality Law Tourism and Social Media Tourism Development and Planning Tourism Economics Travel Industry	APS Common Subjects A-B APS Field Study Area Studies Field Research Project Special Lecture (Asia Pacific Studies)
Culture, Society & Media (CSM) Cultural Anthropology Cultural Studies Education and Society Ethnicity and the Nation State Field Study for Culture, Society and Media Gender Studies Global History Global Media and Conflict Globalization and Law Globalization and Regionalism History of Japanese Foreign Relations Identity and Politics Language and Society	International Relations & Peace Studies (IRP) Comparative Political Economy of the Asia Pacific	Seminar Subjects Field Research Project Graduation Research I-II Introduction to Research Methods Major Seminar I-II



BROADEN YOUR HORIZONS

THE WORLD AT YOUR FINGERTIPS

Build your international portfolio by joining an exchange program for a single semester or a year at one of our international or Japanese partner universities. If you are awarded an APU Tuition Reduction Scholarship, it will still remain valid during your time on an exchange program.

The exchange program has been such a great experience, and I am very glad to have made the decision of doing it for a full year instead of only a semester like many students do. I am now studying at the University of Hertfordshire in the UK as an exchange student. I'm mainly taking media courses and French, but I'm also very involved with music societies on campus. Most of my media classes are a combination of practice and theory, which compliments my studies at APU very well. It is interesting to see how the focus here is more Western whereas the focus in APU is more on the Asia Pacific.

Although I am someone that has already experienced military service and the working world, I dare say that maturity does not necessarily come naturally with age. You will always need to continue to learn and improve yourself on a daily basis. Personally, I am still learning, and although I have come to realize that I can

TWICE THE CHALLENGE, TWICE THE REWARD

The only thing better than getting a degree from one international university is getting two degrees from two international universities at the same time. This option is available to you by signing up for one of APU's dual degree programs with St. Edward's University in the United States and Salzburg University of Applied Sciences in Austria.

function very well independently, I do even better when I have a friend around. Through my studies at APU and in the UK, I have developed a broader perspective on life, and now I know what is truly important to me.

APU is the place to go if you want a genuine international experience. That said, if you want to make full use of your time here, it is best to get out of your comfort zone and grab as many opportunities as you can in order to enrich your life experience. To achieve this, I would strongly encourage you to try an exchange program.

Victor Tou (Singapore)

APS, 3rd Year Student

LIST OF EXCHANGE PARTNERS

AFRICA

Botswana

University of Botswana

Kenya

United States International University

Morocco

Universsite Internationale de Rabat

ASIA

Brunei

Universiti Brunei Darussalam

China

Beijing Normal University-Hong Kong Baptist University United International College
Institute for Tourism Studies, Macau
University of Macau
City University of Hong Kong
Hong Kong Shue Yan University
The Chinese University of Hong Kong
The Hong Kong Polytechnic University
The Hong Kong University of Science and Technology
The University of Hong Kong

Indonesia

BINUS University
Gadjah Mada University
President University
Universitas Katolik Parahyangan
University of Indonesia

Japan

Akita International University
Oita University
Ritsumeikan University

Korea

Dongseo University
Ewha Womans University
Hanyang University
Kookmin University
Korea University
Kyung Hee University
Pusan National University
Sogang University
Sookmyung Women's University
University of Ulsan
Yonsei University

Kyrgyzstan

American University of Central Asia

Malaysia

Taylor's University
Universiti Sains Malaysia
University of Malaya

The Philippines

Ateneo de Manila University
De La Salle University
University of the Philippines

Singapore

Singapore Management University

Taiwan

Feng Chia University
National Chengchi University
National Taiwan Normal University
Tamkang University
Tunghai University
Yuan Ze University

Thailand

Mahidol University
Thammasat University

EUROPE

Austria

MCI Management Center Innsbruck
Salzburg University of Applied Sciences
University of Applied Sciences Upper Austria
University of Applied Sciences bfi Vienna

Azerbaijan

ADA University

Belgium

University of Liege
Vesalius College

Croatia

Zagreb School of Economics and Management

Denmark

Aarhus BSS, Department of Business Development and Technology, Campus Herning
Copenhagen Business School
The University of Copenhagen

Finland

Laurea University of Applied Sciences
Tampere University of Applied Sciences (TAMK)
University of Helsinki

France

Ecole Supérieure des Sciences Commerciales d'Angers – School of Management
ESC AMIENS
Institut Supérieur du Commerce Paris

Neoma Business School
Rennes School of Business

Germany

European University Viadrina Frankfurt (Oder)
Heinrich Heine University
Karlsruhe International University
Otto-von-Guericke-Universität Magdeburg
SRH University Heidelberg
University of Hohenheim
Zeppelin University

Greece

The American College of Greece

Hungary

University of Pecs

Iceland

University of Iceland

Italy

Bocconi University
Ca' Foscari University of Venice
Universita Cattolica del Sacro Cuore

Lithuania

Vilnius University

The Netherlands

Leiden University
The Hague University of Applied Sciences

Norway

BI Norwegian School of Management
Norwegian University for Science and Technology
University of Agder
University of Bergen

Poland

Warsaw School of Economics

Portugal

ISCTE Business School - Lisbon
University Institute

Romania

Romanian American University

Spain

IE University
Universitat Rovira i Virgili
Alicante University

Sweden

Halmstad University
Linnaeus University
Lund University
Södertörn Hogskola

Switzerland

Zurich University of Applied Sciences, School of Management

Turkey

Istanbul Commerce University

UK

Cardiff University
Oxford Brookes University
University of Hertfordshire
University of Kent
University of Leicester

THE AMERICAS

Argentina

Universidad Argentina de la Empresa

Canada

Ecole des sciences de la gestion
Université du Québec à Montréal
HEC Montréal
Schulich School of Business, York University

Simon Fraser University

Saint Mary's University

The University of British Columbia

University of Lethbridge

University of Waterloo

Mexico

Instituto Tecnológico Y De Estudios Superiores de Monterrey
Universidad de Monterrey

USA

American University

Carroll College

City University of New York, Staten Island

Florida International University

Grand Valley State University

James Madison University

Minnesota State University Moorhead

Old Dominion University

San Diego State University

St. Edward's University

The Georgia Institute of Technology

The University of New Mexico

University at Buffalo, The State University of New York

University of Hawaii at Manoa

University of Oklahoma

University of Wyoming

OCEANIA

Australia

Charles Sturt University
James Cook University
La Trobe University
The University of Western Australia
Victoria University

Samoa

National University of Samoa



A CAMPUS LIKE NO OTHER

The moment you set foot on campus, you will notice something very different—true diversity. Take students originating from ninety countries/regions and put them in a space that encourages experimentation and discovery. What results is a completely unique and vibrant community which not only embraces APU's multicultural atmosphere but thrive in it through a colorful array of activities, events, clubs, and societies. No matter what your interests are, APU has a place for you.



MULTICULTURAL WEEKS

Throughout the school year, APU designates several "Multicultural Weeks" where students can showcase the languages and cultures of one country or region. Take the lead as a week organizer or join in these celebrations of world culture as a performer. It is the learning experience of a lifetime.

2016 Academic Year Multicultural Weeks (in alphabetical order)

Bangladesh Week
Chinese Week
Empowerment Week
Fashion Week
Indonesian Week
Korean Week
Nepal Week
Oceania Week
Okinawa Week

Philippine Week
Sri Lankan Week
Taiwan Cultural Week
Thai Week
Uzbekistan Week
Vietnamese Week



A few of the student-led organizations on campus (in alphabetical order)

Animation Research Club
APU Karate Club
APU Soccer Club
APU Tea Ceremony Club
Global Business Leaders
Habitat APU
International Relations Student Association
"K-Muse" K-pop Dance Troupe
"Musy Tone" International Singing Club

Ones'1 Fair Trade Club
"PRENGO" Overseas Volunteering Club
Rugby Club
"Symbio" Conservation Club
Wadaiko "Raku" Japanese Drumming Club
Women's and Men's Lacrosse Teams
"Yosha-koi" Japanese Dance Troupe

YOUR HOME AWAY FROM HOME

UP IN THE CLOUDS

APU is located on top of a small mountain at an altitude of 330 meters with beautiful natural surroundings and overlooks the city of Beppu and its coastline. This amazing view is just the beginning of what you will find here on campus. Modern buildings, quiet study rooms, sports and health related facilities, on-campus housing, and a variety of spaces for you to meet and collaborate with your classmates are all available to create the perfect learning environment.

ON-CAMPUS FACILITIES/AMENITIES

- Student union building with a cafeteria, café, convenience store, Japanese tea ceremony room, meeting spaces, and music/dance studios
- Multipurpose auditorium
- State-of-the-art library and media center
- Gymnasium and workout facilities
- Athletic track
- Multipurpose fields for soccer, rugby, lacrosse, baseball, etc.
- Basketball courts
- Health clinic and counseling room
- Outdoor amphitheater
- Local food trucks
- ATMs
- Postal services

PEER STUDENT SUPPORT

For most aspects of student life, you will not only receive support from university staff and faculty but also from passionate student groups such as the Fellow Advisory Group, Student Activity Station, and Academic and Learning Core Staff. You will feel at ease from your first day and naturally become a member of the campus community.



NOT YOUR TYPICAL DORMITORY

With students from diverse cultures living under one roof, the time you will spend in our on-campus residence hall, AP House, is an unforgettable experience. This unique setting enables you to adapt to your new life in Japan and learn about the cultures of the world through interaction with peers while having a private space to concentrate on your studies. To assist you with this transition, each floor has experienced students selected as resident assistants (RAs) who will answer your questions and concerns and hold activities for you to join.

ROOM OPTIONS

You have the option of living in a single or shared room. Shared rooms allow you to have an even greater intercultural experience as you will be living with a Japanese roommate. These rooms are separated by a lockable sliding door for your privacy. All rooms are fully furnished.

Single Room

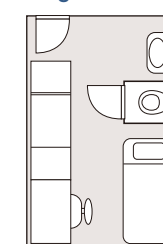

Shared Room

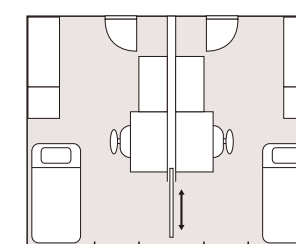

AP HOUSE STATISTICS

100% guaranteed housing for international students in their first year

378 shared rooms

932 single rooms

1,127 residents

60.1% international students

52 countries and regions represented

44 communal kitchens

39,000 JPY monthly rent including utilities

0 JPY to use laundry facilities

0 JPY to use the internet

AP HOUSE FACILITIES

- Private shower rooms
- Japanese-style public baths
- Computer rooms
- Study rooms
- Small convenience store
- 24 hour security
- Indoor recreation facilities like billiards
- Outdoor basketball courts
- Air conditioning unit in each dorm room

*Fees are subject to change.



SETTLING IN

EXPERIENCE JAPAN

Japan is not only the world's third largest economic center but also one of the most popular travel destinations thanks to its rich traditional and modern culture combined with beautiful landscapes. The country also prides itself on cutting-edge technology and maintaining one of the highest safety records found anywhere in the world. For the ideal location to earn your university degree, look no further.

LOCATION IS KEY

APU's campus is located in Kyushu, the southernmost major island of Japan, in the bayside city of Beppu. Enclosed by beautiful mountains and the sparkling Beppu Bay, the city's historic backstreets and abundance of hot spring baths make it one of Japan's most visited cities by Japanese and international tourists alike. Beppu is a very safe city with a low cost of living compared to other popular study destinations in Japan and abroad. Dive into the local culture by participating in festivals, sporting events, and other activities alongside the welcoming community.

DOWNTOWN LIVING

From your second year, you will move off campus into downtown Beppu and choose among living in an independent student dormitory, private apartment, or shared student housing. APU provides support to help you make the transition from on-campus to off-campus accommodation. You will find many entertainment options such as shopping malls, cafes, karaoke, bowling, and restaurants with international food.

ALL IN A DAY'S WORK

Part-time jobs are another option for you to gain real world experience. You are allowed to work on or off campus for up to 28 hours a week during the semester and 40 hours a week during vacations. APU offers to help you obtain the correct work permit before you start to work. Please note that availability of part-time work may vary. Additionally, while on-campus jobs may not require Japanese language ability, off-campus jobs often require at least a conversational level of Japanese.

STAYING HEALTHY

With an abundance of clean drinking water, fresh air, beautiful parks, riverside recreation spaces, seaside walking paths, sports facilities as well as medical centers, Beppu supports your healthy lifestyle. Another advantage is that, as an APU student, you will be covered by Japan's National Health Insurance.

BEPPU AT A GLANCE

119,741 total residents

4,147 international residents

2,217 hot springs

NO.1 in Japan **NO.2** in the world
for amount of hot spring water

1,374 METERS Tsurumidake,
Beppu's tallest mountain

AVERAGE TEMPERATURE

JANUARY 5 °C / 41 °F	APRIL 14 °C / 57 °F
JULY 28 °C / 82 °F	OCTOBER 20 °C / 68 °F

POPULAR LOCAL FOOD

- *Toriten* (Beppu-style fried chicken)
- *Jigoku mushi ryori* (hot spring steamed cuisine)
- *Shiitake* mushrooms

CREATING A BRIGHTER TOMORROW

SECURE YOUR FUTURE

With the knowledge, skills, language ability, and experience you obtain at APU, there are no limits or boundaries to where your degree will take you. Accordingly, we have an unprecedented job placement rate of 91.6% for our students seeking employment in Japan and beyond. Equip yourself with the skills needed to compete for jobs at the highest level in multinational organizations with APU's Career Office support.

TESTING THE WATERS

Gain insight on the working world by joining APU's internship programs and directly connect your studies to your career goals. There are specific programs for which you can earn academic credits as well.

LEARN FROM THE PROS

From business leaders to societal movers and shakers, you will have the chance to interact with prominent figures in various fields through seminars by guest speakers. Stay updated on current trends, ask for career advice, and define where you would like to be in the real world.

EXPLORE YOUR OPTIONS

The potential of our students has caught the attention of major corporations and international organizations around the world. In fact, in the past year alone, over 350 companies and organizations visited APU to specifically recruit our students for a variety of employment positions in Japan and overseas, meaning you do not even need to leave campus to get your foot in the door. Many students also pursue higher education after graduation, continuing on at one of APU's graduate schools or another institution.

List of major employers (For 2015 Academic Year)

Accenture Japan Ltd.
Adecco Ltd.
All Nippon Airways Co., Ltd.
Apple Japan G.K.
Bandai Namco Games Inc.
Clarion Co., Ltd.
Dell, Japan Inc.
Ebara Corporation
Fujitsu Limited
Google Inc.

Hitachi High-Tech Science Corporation
Hoshino Resort Co., Ltd.
Japan Airlines Co., Ltd.
Japan Aviation Electronics Industry, Limited
Japan Petroleum Exploration Co., Ltd.
JTB Pte. Ltd.
Kobe Steel, Ltd.
Mitsui Chemicals, Inc.
Mizuho Financial Group, Inc. (MHFG)
NEC Corporation

Nippon Steel & Sumitomo Metal Corporation
Nissan Motor Co., Ltd.
Nittsu Shoji Co., Ltd.
NTT Docomo, Inc.
Resona Bank, Limited
Robert Walters Japan K.K.
Septeni Holdings Co., Ltd.
Sumitomo Life Insurance Company
Toshiba Corporation
Toyota Tsusho Corporation

List of major graduate schools (in country/region's alphabetical order)

Australian National University, Royal
Melbourne Institute of Technology, Australia
University of Melbourne, Australia
University of Sydney, Australia
Carleton University, Canada
Simon Fraser University, Canada
Copenhagen Business School, Denmark
Friedrich-Alexander Universitat Erlangen-
Nurnberg, Germany
Trier University of Applied Sciences, Germany
The Chinese University of Hong Kong, Hong
Kong

City University of Hong Kong, Hong Kong
Keio University, Japan
Kyoto University, Japan
Meiji University, Japan
Nagoya University, Japan
Sophia University, Japan
University of Tokyo, Japan
Waseda University, Japan
Victoria University of Wellington,
New Zealand
Graduate Institute of International and
Development Studies, Switzerland

Assumption University, Thailand
Tilburg University, The Netherlands
University of Bath, UK
University of Birmingham, UK
Lancaster University, UK
London College of Fashion, UK
University of Glasgow, UK
Case Western Reserve University, USA
Johns Hopkins University, USA
University of Michigan, USA
Tulane University, USA

ALUMNI JOURNEYS

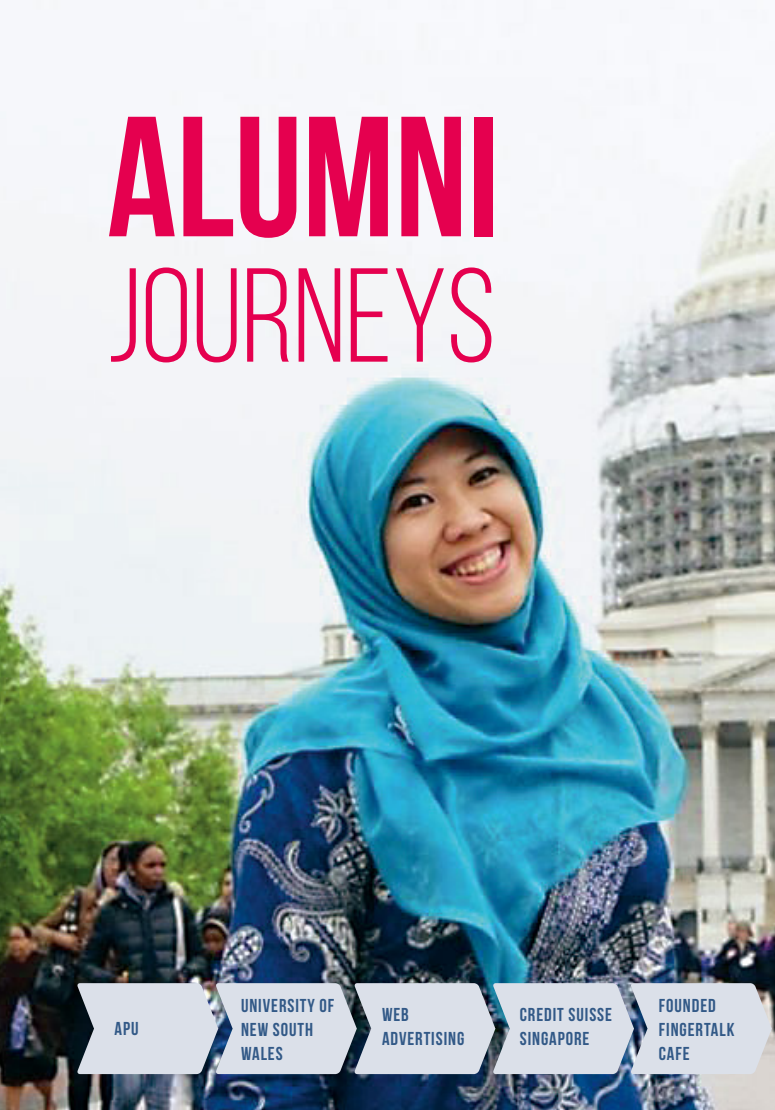

APU → UNIVERSITY OF NEW SOUTH WALES → WEB ADVERTISING → CREDIT SUISSE SINGAPORE → FOUNDED FINGERTALK CAFE

After graduating from APU, I pursued my master's degree in professional accounting at the University of New South Wales in Sydney, Australia. After completing the program, I moved back to Tokyo, Japan and worked for a web advertising company for one year before I found a volunteering opportunity in Nicaragua. During my three months in Granada City, Nicaragua, I happened upon a cafe where all the staff were deaf, and that struck a chord in me.

I went on to Singapore to work as an equity analyst for Credit Suisse Singapore. But after experiencing that cafe in Nicaragua, I began to dream of opening a business which would provide income for people with disabilities, and so I started gathering the pieces to make this a reality. In 2015, I achieved my dream as Fingertalk Cafe was born. The cafe is located in Tangerang, Indonesia and not only employs deaf people, but also encourages its customers to learn sign language. I recently left my job at Credit Suisse Singapore to fully focus on this endeavor, which has now expanded into two cafes, a craft workshop, and a car wash service, with plans to expand even further.

APU gave me a lot of useful knowledge I have utilized in my various professional roles. The ability to speak Japanese well gave me an advantage in working with Japanese clients at Credit Suisse while my APM classes have been especially beneficial in current role as the founder of Fingertalk. I felt grateful for the classes I took at APU specifically to learn the foundations of such skills as effective team management, financial reporting, and fundraising. Additionally, APU's multicultural environment taught me to be adaptive and flexible to cultural differences. In my case this also includes "deaf culture" – another culture that I must understand in order to succeed.

Dissa Syakina Ahdanisa (Indonesia)

APM, graduated in 2010
Lives in: Indonesia



APU → TRAINEESHIP AT THE EU PARLIAMENT → UNIVERSITY OF OXFORD → RITSUMEIKAN UNIVERSITY

One of the most valuable things you will get at APU is lifelong friendships. I remember that when I lived in the dorm, I often ventured out with my friends in the middle of the night to gaze at the sky from the campus. The stars we could see were absolutely beautiful, and the night view of Beppu Bay was breathtaking.

Living alongside with students from all over the world provided me with a greater awareness of different cultures and their local values. I realized that conflicts between states, and relations in general, are largely an arbitrary construction based on perception and interaction. As a result, this led me to discover my passion for researching about the mechanisms behind international relations. After completing my undergraduate studies at APU, I moved to Belgium for a traineeship at the EU Parliament. Following this, I did my master's degree in global governance and diplomacy at the University of Oxford, UK. In April 2017, I began my doctoral research at Ritsumeikan University in Kyoto, Japan.

APU taught me so much about myself, about the world we live in, and about my career focus. The joy and life provided is a once-in-a-lifetime experience, and the years just fly by. Regardless of whether you struggle with your studies, with learning the Japanese language, or adjusting to the multicultural environment on campus, you will always find people at APU genuinely happy to help you. They are the ones who will eventually become your very best friends, and they might even be willing to brave the night cold in search of a shooting star.

Andrei Malai (Germany)

APS, graduated in 2014
Lives in: Japan

After graduating from APU, I worked briefly for a Japanese marketing company and an outsourcing company in Tokyo before getting a job at Bloomberg News. I'm now a news data editor covering economic indicators, energy, and commodity news for Japan and other Asian markets. I publish tables, charts, and short news stories for a global audience comprised of finance experts, business professionals, and policy-makers in both the public and private sectors. It's my desire to be an accomplished writer and journalist, and someday publish a book. Also, I hope to launch my own projects and turn them into revenue-generating business ventures. I have already started working on one media project called Tokyo Interlopers, a collection of individual stories of foreigners in Japan, aiming to promote diversity and inclusion in Japanese society.

In my current work, I often apply accounting and business principles I learned at APU. I also get to practice my intercultural communication skills that I gained through interacting with other international students. My Japanese language and cultural knowledge come into play on a daily basis when dealing with clients and colleagues. These skills have been crucial since the start of my career, and without them it would have been difficult to navigate Japan's corporate environment.

My message to you is to find what you enjoy best and keep doing it. Be a self-starter. Don't just wait for instructions because instructions won't take you far. Always take the initiative and determine your own future.

Isaac Aquino (The Philippines)

APM, graduated in 2007
Lives in: Japan



APU → MARKETING → OUTSOURCING → BLOOMBERG NEWS

After graduating from APU, I joined an IT solution company in Tokyo and worked there for three years. In 2011, I went back to Mongolia to set up my own company, ABico LLC, to introduce Japanese daily-life products into the Mongolian market. I also co-founded Meets Japan LLC in 2016 to open Mongolia's first Japanese-style one dollar store and currently have eight stores throughout the country. It has been so rewarding to be able to promote new ideas and lifestyles in Mongolia through these Japanese products and make a direct impact on people's everyday lives.

Managing two companies as president obviously requires enormous responsibilities. However, I believe the knowledge and skills I gained during my four years at APU prepared me for this challenge, namely multitasking, teamwork, respecting others, and always believing in yourself. Most importantly, I learned that while the amount of growth we can achieve on our own may be limited, we can grow tremendously if we all work together. I have reflected on this philosophy in my own company, and it is why I named it ABico, which means "growing together" in Mongolian. While continuing to expand my business, I want to provide opportunities for as many people as I can to develop both professionally and personally, which I believe will lead to a better society overall.

I wouldn't be where I am today without all of the experiences I had or all of the friendships and networks I made at APU. Make the most of every moment at APU; every day is a new opportunity to learn and grow, which will guide you to your future path.

Tsend Uugantsetseg (Mongolia)

APS, graduated in 2008
Lives in: Mongolia

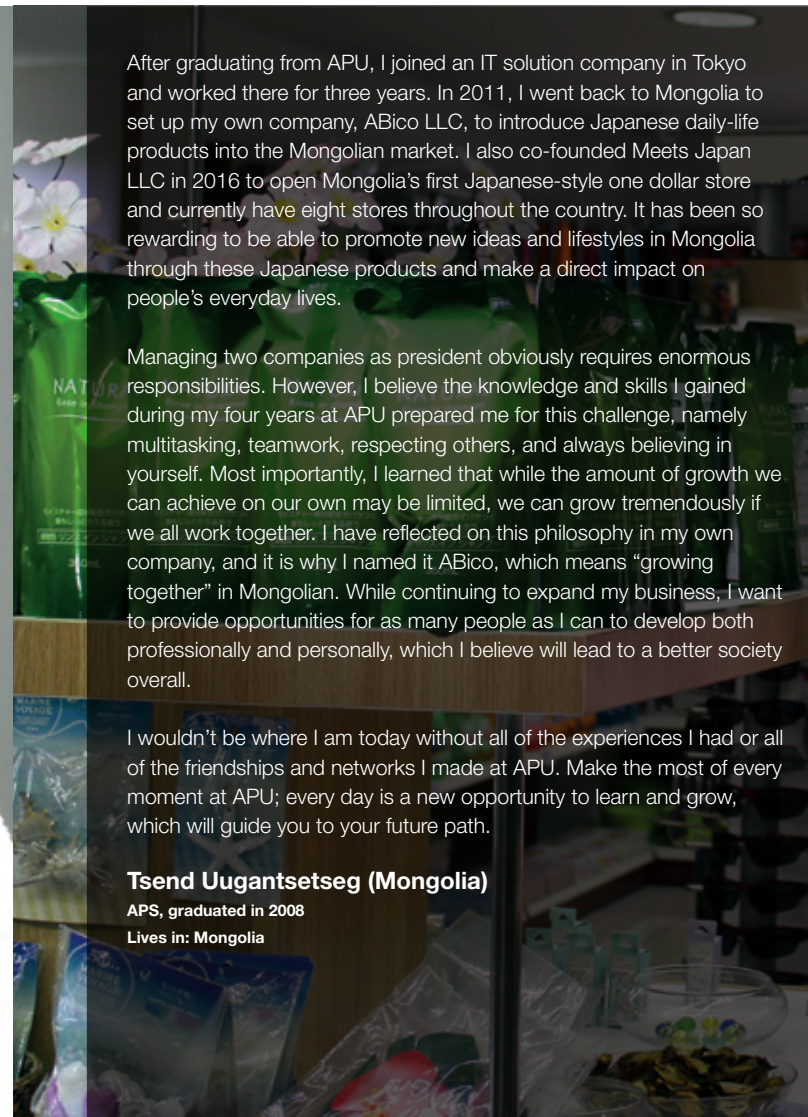

APU → IT SOLUTIONS → FOUNDED ABICO LLC IN MONGOLIA → CO-FOUNDED MEETS JAPAN LLC

FEES AND SCHOLARSHIPS

FEES FOR INITIAL YEAR OF STUDY

	FIRST YEAR	SECOND YEAR TRANSFER	THIRD YEAR TRANSFER
Program Duration	4 years	3 years	2 years
Admission Fee	130,000 JPY (1,130 USD)	130,000 JPY (1,130 USD)	130,000 JPY (1,130 USD)
Tuition	1,328,000 JPY* (11,548 USD)	1,412,000 JPY (12,278 USD)	1,412,000 JPY (12,278 USD)
Comprehensive Renters' Insurance	16,200 JPY (141 USD)	12,380 JPY (108 USD)	8,540 JPY (74 USD)
AP House Entrance Fee	188,000 JPY (April) / 168,500 JPY (September) (1,635 USD (April) / 1,465 USD (September))		
AP House Monthly Rent	39,000 JPY (339 USD)	39,000 JPY (339 USD)	39,000 JPY (339 USD)

*Tuition for the second to the fourth year of study is 1,412,000 JPY per year.
US dollar equivalents are for REFERENCE ONLY, based on the rate of 1:115. All fees must be paid in Japanese yen.
Fees listed above are subject to change.

Admission Fee

The admission fee is required for all students, regardless of scholarship amount, and is usually due within approximately four weeks after admission result notification. This fee is non-refundable under any circumstance.

Tuition

A partial payment of your first semester tuition is due in order to complete your enrollment procedures. The remaining tuition will be due at a later time. For APU Tuition Reduction Scholarship recipients, this amount will decrease based on the percentage awarded.

Comprehensive Renters' Insurance

This insurance is for protection in case of liability, and its fee is required from all students, regardless of scholarship amount.

AP House Entrance Fee

This fee is required for all students, regardless of scholarship amount. The fee includes a moving-in fee (32,000 JPY), security deposit (78,000 JPY), and rent (39,000 JPY per month) for two months for April enrollees and for one and half months for September enrollees.

LIVING EXPENSES

Living expenses for a year (including rent listed above) amount to approximately 900,000 JPY (approx. 7,826 USD).

SCHOLARSHIPS

APU awards Tuition Reduction Scholarships to outstanding international students. These cover 30%, 50%, 65%, 80%, or 100% of your tuition until graduation. You are eligible to apply if you will hold a student visa while studying at APU. Additional scholarships are available after enrollment. Scholarships at APU are primarily merit based.

APPLY TO APU

<https://admissions.apu.ac.jp>

APPLICATION PERIOD

April 2018 enrollment:

June 5, 2017 (Mon) - October 18, 2017 (Wed)

September 2018 enrollment:

September 18, 2017 (Mon) - March 28, 2018 (Wed)

If you reside in Japan, China, India, Indonesia, Korea, Thailand, Uzbekistan, or Viet Nam, visit the admissions website for additional information.

MINIMUM REQUIREMENTS FOR ADMISSION

Education:

First year applicants: 12 years or equivalent of standard education

Transfer applicants: 13-14 years or equivalent of standard education

Minimum Language Test Score for English-basis Applicants:

TEST	FIRST YEAR	TRANSFER
TOEFL® iBT Test	61	79
TOEFL® PBT Test	500	550
TOEIC® L&R Test *1	700	780
IELTS	5.5	6.0
EIKEN	Pre-1	1
PTE Academic	45	50

Minimum Language Test Score for Japanese-basis Applicants:

TEST	FIRST YEAR	TRANSFER
JLPT N1	90	100
JLPT N2	100	135
EJU (Japanese)	220*2	250*2

*1 L & R is an abbreviation for LISTENING AND READING

*2 not including the writing section

APPLICATION PROCESS

- Complete the online application at <https://admissions.apu.ac.jp>
- Submit all required supporting documents (originals and certified copies) by post
- Pay the application fee by credit card or bank transfer
 - If you reside outside Japan: 5,000 JPY
 - If you reside in Japan: 35,000 JPY
- Wait for APU to screen your documents and contact you to arrange an interview
- Have an interview online, by telephone, or in person
(If you live outside Japan, it is not necessary for you to travel to Japan for your interview.)
- Receive screening results from APU by post and online

Your result notification will include both admission and scholarship screening results. If you are accepted to APU, you will be expected to submit additional documents by post and pay enrollment procedure fees. APU will apply for a Certificate of Eligibility (COE) on your behalf via the Immigration Bureau using the documents you provide. With this certificate, you can apply for a student visa at your local Japanese embassy or consulate.

CONTACT US

There are APU offices in the following countries and regions. You are encouraged to make inquiries at your local offices where possible. If you live in a country without an APU office or representative, please contact the APU Admissions Office directly.

APU ADMISSIONS OFFICE

Ritsumeikan Asia Pacific University
1-1 Jumonjibaru, Beppu, Oita 874-8577 Japan
Tel: +81-977-78-1119
Fax: +81-977-78-1121
<https://admissions.apu.ac.jp>
Email: welcome@apu.ac.jp



Ritsumeikan.APU



APUAdmissionsOffice



ritsumeikanapu

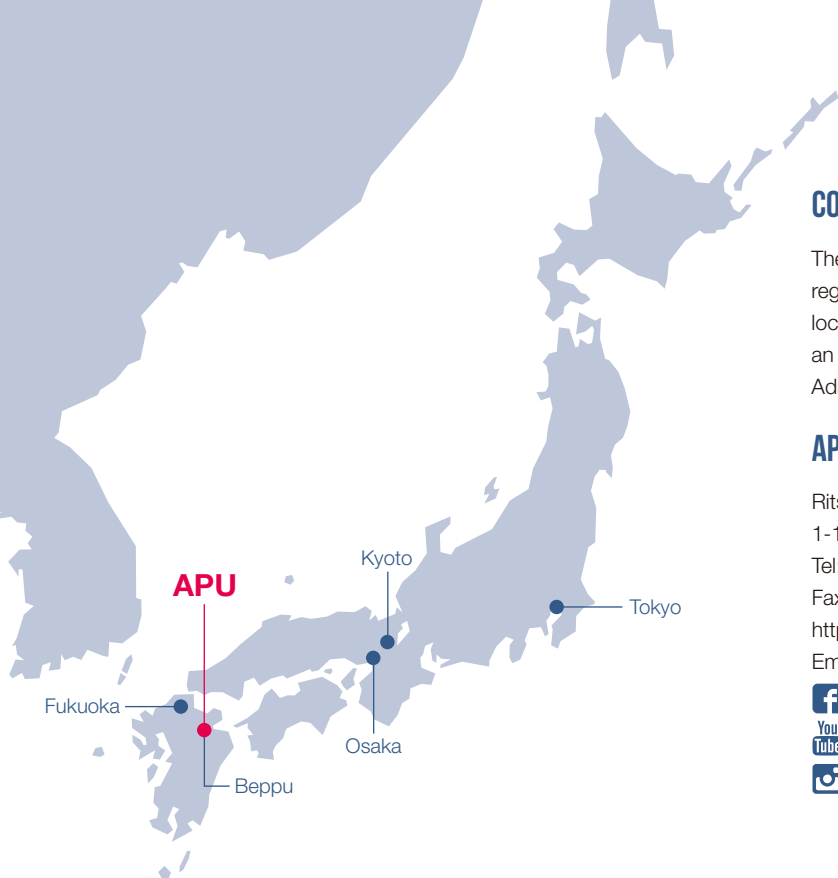

APU OVERSEAS OFFICES

CHINA

Ritsumeikan Liaison Office – Shanghai
Jiaotong University
D, 18F Shentong Xinxi Guangchang, No. 55,
Huaihai West Rd
Shanghai City 200030, China
Tel: +86-21-6283-5104
Fax: +86-21-6283-5247
Email: apuchina@apu.ac.jp

KOREA

APU Korea Office
#608, Halla Classic Officetel 6th Floor,
23 Gangnam Daero 84 Gil,
Gangnam-gu, Seoul 135-934 Korea
Tel: +82-2-564-3425/3426
Fax: +82-2-564-3427
<http://www.ritsapu-kr.com>
Email: hello@ritsapu-kr.com

VIET NAM

APU Viet Nam Office
A31D11, Alley 66/1, Lane 84
Tran Thai Tong St., Cau Giay District,
Hanoi, Vietnam
Tel: +84-4-32-000-619
<http://vietnam.apu.ac.jp>
Email: vietnam@apu.ac.jp
 [apuvietnam](https://www.facebook.com/apuvietnam)

INDONESIA

APU Indonesia Information Center
C/O MARQUEE, Mayapada Tower I,
11th Floor, Jl.Jend. Sudirman Kav. 28
Jakarta 12920, Indonesia
Tel: +62-21-5289-7328/7392
Email: apu-ina@apu.ac.jp
 [apuindonesiaoffice](https://www.facebook.com/apuindonesiaoffice)

THAILAND

APU Thailand Office
1015 Room, 10th Floor, Serm-mit Tower
159/16 Soi Asoke,
Sukhumvit 21 Road, Wattana, Bangkok
10110 Thailand
Tel/Fax: +66-2-665-7145
Email: thailand@apu.ac.jp

TAIWAN

APU Taiwan Office
C/O MIBC, F10F., NO. 209, Sec. 1,
Civic Blvd., Datong Dist., Taipei City 103
Tel: +886-2-2181-1666
Email: taipei@apu.ac.jp
 [APUTW](https://www.facebook.com/APUTW)

APU OVERSEAS REPRESENTATIVES

INDIA

Mr. Vishnu Vankayala
4th Floor, Vansh Building, AP-801, 1st Street,
G-Block,
10th Main Road, Anna Nagar, Chennai-040,
Tamil Nadu, India
Tel: +91-44-4352-2078
Email: s-india@apu.ac.jp

SRI LANKA

Mr. Harin Gunawardena
183/1, Nawala Road, Nugegoda, Sri Lanka
Tel: +94-714251314
Email: harin@apu.ac.jp



TOP GLOBAL
UNIVERSITY
JAPAN